

UCLA College Social Sciences

CSW
CENTER FOR THE STUDY OF WOMEN

B A R B R A
STREISAND
C E N T E R

Thinking Gender 2023

TRANSFORMING RESEARCH:

Feminist Methods for Times of
Crisis and Possibility

February 24, 2023
UCLA Covel Commons

*33rd Graduate Student
Research Conference*

IMPORTANT INFORMATION

CHECK-IN/REGISTRATION: Registration tables are located in the Lobby on the 3rd floor of Covell Commons. CSW|Streisand Center staff will be wearing gold name badges with the CSW|Streisand Center logo and will be available to provide assistance throughout the conference.

FOOD AND REFRESHMENTS: Complimentary refreshments are available in the morning, afternoon, and during the reception for registered guests. Guests may also purchase food, snacks, and coffee at nearby campus locations. Please see page 10 for a list and map of nearby eateries. Note that the food trucks outside the venue only accept UCLA BruinCards for payment.

INTERNET ACCESS: Guests can access Wi-Fi through the network “UCLA_WEB.” No password is required. The “eduroam” network is also accessible to guests from other campuses that participate in “eduroam.” You may log in using your own campus credentials.

NOTICE OF PHOTOGRAPHIC AND MEDIA RECORDING: Photography, audio, and video recording may occur at this event. By entering the event premises, you consent to interviews, photography, audio recording, video recording, and their release, publication, exhibition, or reproduction to be used for news, webcasts, promotional purposes, telecasts, advertising, inclusion on websites, or any other purpose by the UCLA Center for the Study of Women|Barbra Streisand Center.

The UCLA Center for the Study of Women|Streisand Center acknowledges the Tongva peoples as the traditional land caretakers of Tovaangar (Los Angeles basin, So. Channel Islands) and are grateful to have the opportunity to work for the taraaxatom (indigenous peoples) in this place. As a land grant institution, we pay our respects to Honuukvetam (Ancestors), 'Ahihirom (Elders), and 'eyoohiinkem (our relatives/relations) past, present and emerging.

THINKING GENDER 2023:

“Transforming Research: Feminist Methods for Times of Crisis and Possibility”

February 24, 2023 (UCLA, Covel Commons, Grand Horizon Ballroom)

Conference Overview

(All times in Pacific Standard Time)

7:30 AM - 8:30 AM REGISTRATION

Location: 3rd Floor Lobby

8:30 AM - 8:45 AM WELCOME

Location: Salon A

8:45 AM - 10:00 AM PRESENTATION BY T.L. COWAN AND JAS RAULT

Heavy Processing for Networked Intimate Publics (NIPs): Trans-Feminist & Queer Digital Methods in and Beyond the University

Location: Salon A

10:00 AM - 10:30 AM UNDERGRADUATE POSTER SESSION

Location: South Promenade

10:30 AM - 12:00 PM GRADUATE STUDENT PRESENTATIONS SESSION 1

Panel 1: Co-Producing Knowledge

Location: North Salon

Panel 2: Archive and Archiving

Location: South Salon

12:00 PM - 1:15 PM NETWORKING LUNCH *(for presenters and invited guests only)*

Location: Terrace

1:15 PM - 2:45 PM GRADUATE STUDENT PRESENTATIONS SESSION 2

Panel 3: On Methods: Limitations and Possibilities

Location: North Salon

Panel 4: Crafting and Performing Research

Location: South Salon

2:45 PM - 3:00 PM Break

3:00 PM - 4:15 PM PRESENTATION BY CELINE PARREÑAS SHIMIZU

Creativity in the Face of Devastation:
Methodologies of Research and
Practice Across Inequality

Location: Salon A

4:15 PM - 4:30 PM BREAK

**4:30 PM - 6:15 PM SCREENING OF *THE CELINE ARCHIVE*
AND Q&A WITH CELINE PARREÑAS
SHIMIZU AND ALEXANDREA KAYE
PETALVER**

Location: North Salon

**GRADUATE STUDENT WORKSHOP
WITH T.L. COWAN AND JAS RAULT**

*(for graduate students only; sign up
on site at Cowan and Rault's morning
presentation):*

From Networked Intimate Publics (NIPs)
to Networked Accountable Publics
(NAPs): Making Time for Collaboration,
Friendship & Comradeship in Research

Location: South Salon

6:15 PM - 6:30 PM Break

6:30 PM - 7:30 PM Reception

Location: Terrace

A virtual media exhibit will also be available to in-person conference attendees.

PANEL AND PRESENTER DETAILS

8:45 AM - 10:00 AM

PUBLIC PRESENTATION

T.L. COWAN AND JAS RAULT

“Heavy Processing for Networked Intimate Publics (NIPs): Trans-Feminist & Queer Digital Methods in and Beyond the University”

Location: Salon A

What kinds of small-world-facing methods do we need to make big-world-facing projects? Based in a joke that we decided to take very seriously, we consider heavy processing to be an information technology that runs on a desiring, pleasurable and hard-working set of attachments and sensibilities to relationship-based, complex knowledge formation, and we reflect on the ways that this method is informed by a long history of trans-feminist queer (TFQ) practices. Heavy processing is a research method that seeks not only to get consent, to communicate care, to clean your data, or to publish your findings and a research orientation to the pleasure (sexual, emotional, political, intellectual) of complex and sometimes incommensurate information. It is not only about accessing, collecting, storing, sharing, and circulating information, but about being transformed by that information.

T.L. Cowan (she/they) is Assistant Professor of media studies in the Department of Arts Culture and Media (UTSC) and the Faculty of Information at the University of Toronto, as well as a cabaret and video artist. Their research focuses on cultural and intellectual economies and networks of minoritized digital media and performance practices. Her creative-research practice moves between page, stage, and screen.

Jas Rault (they/them) is an Assistant Professor of media studies in the Department of Arts, Culture, Media (UTSC) and the Faculty of Information at the University of Toronto. Rault’s research focuses on trans-feminist and queer digital praxes and protocols; media histories of settler coloniality, white supremacy and sexuality; aesthetics and affects of social movements.

Together, Cowan and Rault co-direct three online research environments: the Cabaret Commons, the Digital Research Ethics Collaboratory (DREC), and the Critical Digital Methods Institute (CDMI).

10:00 AM - 10:30 AM

UNDERGRADUATE POSTER SESSION

Location: South Promenade

HeeJoo Roh and Hope Lockwood, English, Pepperdine University

Understanding Abjection: Bridging the Gaps Between the Humanities and Social Sciences

Olivia Norvell, Gender Studies and English, University of Vermont

Becoming a Woman: Interpretations of Sex and Gender in Simone de Beauvoir's The Second Sex

Isabella Villa Real Seabra, Neuroscience and Gender Studies, Barnard College

Social Justice Movements for Abortion and Sex Worker Decriminalization and Their Approach to Human Rights in Mainstream Feminism

10:30 AM - 12:00 PM

GRADUATE STUDENT PRESENTATIONS, SESSION 1

PANEL 1

CO-PRODUCING KNOWLEDGE

MODERATOR: **Amy Ritterbusch** (Social Welfare, UCLA)

Location: North Salon

Nicole V. Bush and Christianna Clark, Communication, University of Southern California [Bush]; Education and Psychology, Pepperdine University [Clark]

Sex Work & the Digital Labor Void: Enforced Invisibility, and Meta's Exclusion of Sex Workers

Anzi Dong, Gender Studies, Arizona State University

Dissident Friendship in the Age of Neoliberal Divisions: Co-producing Community-Based Insurgent Knowledge with Migrant Women Activists in Shenzhen, China

Nelanthi Hewa, Information, University of Toronto

Interviewing Interviewers: Collaborative Research and the Gatekeeping of Authority

Brianna Simmons, Anthropology, UC Riverside

Fieldworking While Black: Freedom Questions and the Plantocratic Nature of Anthropology

PANEL 2

ARCHIVE AND ARCHIVING

MODERATOR: **Michelle Caswell** (Information Studies, UCLA)

Location: South Salon

Joana Chavez, Chicana/o and Central American Studies, UCLA

Testimonio(s) as a Healing Informed Method

Kanika Lawton, Cinema Studies and Sexual Diversity Studies, University of Toronto

Devisualizing the Archive: Refusal as Queer/Trans Commitment

LuLing Osofsky, Art and Visual Culture, UC Santa Cruz

Ice, Seeds, and Memory: Anarchival Art on the Arctic Island of Svalbard

1:15 PM – 2:45 PM

GRADUATE STUDENT PRESENTATIONS, SESSION 2

PANEL 3

ON METHODS: LIMITATIONS AND POSSIBILITIES

MODERATOR: **Anurima Banerji** (World Arts and Cultures/Dance, UCLA)

Location: North Salon

Lamiae Bouqentar, Communication, University of Montreal

Interweaving Arab Queerness in Migratory Contexts: A Methodology of Bricolage

Miranda Hoegberg and Tomasz Groza, English, UCLA [Hoegberg]; Architecture, UCLA [Groza]

The Harlot's House: Using Architectural Practice to Reimagine Eighteenth-Century Fictions

Kelsey Kim, Anthropology, UCLA

Oral Histories of Environmental Illness: Legitimizing Experiences and Alternative Ways of Knowing

Koda Sokol and Willie Guerrero, Sociology, UC Santa Cruz

A Dialogue on Theories of the Subject

PANEL 4

CRAFTING AND PERFORMING RESEARCH

MODERATOR: **Nguyễn Tân Hoàng** (Literature, UC San Diego)

Pharren Miller, Sociology, UCLA

Reclaiming OUR Time: Centering Jazmine Sullivan's Heaux Tales in the Black Feminist Tradition of Safe Spaces

Lalu Esra Ozban, Film and Digital Media, UC Santa Cruz

Koli Sinemaları: A Transfeminist Research-Archive-Creation

Balakrishnan Raghavan, Cross-Cultural Musicology, UC Santa Cruz

At Odds with Even Love - Utopia in Performance

Clara Lemme Ribeiro, Geography, University of Washington, Seattle

The Machine of the World: A Zine on Modernity and Decolonization

3:00 PM - 4:15 PM

PUBLIC PRESENTATION

CELINE PARREÑAS SHIMIZU

"Creativity in the Face of Devastation: Methodologies of Research and Practice Across Inequality"

Location: Salon A

This session encourages participants to explore the various, even infinite dimensions of expression in order to test the limits and possibilities of actualizing our ideas whether in poetry, filmmaking, performance, and scholarly/creative and personal/analytic writing. Practices of reading, citation, the identification of subjective/structural location, and community building in creative collaboration will be investigated so we may identify our particular practices and approaches and their stakes, risks and costs. We particularly attend to the histories of harms within our fields and disciplines as we inventory the purposes and questions guiding our work.

Celine Parreñas Shimizu, film scholar and filmmaker, is Dean of the Division of Arts and Distinguished Professor of film and digital media at the University of California at Santa Cruz. She wrote *The Proximity of Other Skins* (2020), *Straitjacket Sexualities* (2012), and *The Hypersexuality of Race* (2007) and co-edited *The Feminist Porn Book* (2013) and *The Unwatchability of Whiteness* (2018). Her recent films *The Celine Archive* (2020) and *80 Years Later: On Japanese American Racial Inheritance* (2022) won several festival awards.

4:30 PM - 6:15 PM

FILM SCREENING AND Q&A

The Celine Archive (2020) Courtesy of **Women Make Movies**



FILMMAKER: **Celine Parreñas Shimizu**

Q&A PANELISTS: **Celine Parreñas Shimizu and Alexandra Kaye Petalver**

Location: North Salon

Adulteress, traitor, heroine, or prey? In 1932, Celine Navarro was buried alive by her community in Northern California. This film digs up herstory. The filmmaker, a grieving mother, with a long-term commitment to exploring race, gender, and immigration, digs up Celine Navarro's story, exposing silences that haunt Filipin@x American communities today, along with Celine Navarro's family, community members and scholars who know different details about this largely untold event in American history.

GRADUATE STUDENT WORKSHOP

(For graduate students only; sign up on site at Cowan & Rault's public presentation)

"From Networked Intimate Publics (NIPs) to Networked Accountable Publics (NAPs): Making Time for Collaboration, Friendship & Comradeship in Research"

FACILITATORS: **T.L. Cowan and Jas Rault**

Location: South Salon

In this workshop we gather participants to think about how intimacy and accountability might be centered in our research relationships and practices. Networked Intimate Publics run on heavy processing technologies programmed for complex practices of accountability. Intimate accountability in research relationships does not come easily or "naturally"; it is not a given when people come together to work towards TFQ anti-racist anti-colonial crip and/or anti-capitalist goals. For our time together, we will use crip-leaning TFQ methods in which participants will be asked to reflect on the skills, values, and experiences they bring to their research, and how to use NIPs and NAPs structures and tools to

EATERIES



Anderson Café, located in Anderson School of Management, offers Starbucks coffee, espresso drinks, pastries, made-to-order Mediterranean bowls, specialty sandwiches, and grab and go lunch options.

Avenue A, located on A-Level in Ackerman Student Union, offers restaurants such as Taco Bell, Carl's Jr, Kikka Sushi, and more.

Kerckhoff Coffeehouse, located in Kerckhoff Hall near Ackerman Student Union, offers coffee, tea, other beverages, and some grab-and-go items.

Plateia, located in Meyer and Renee Luskin Conference Center, offers Mediterranean-inspired cuisine made with fresh ingredients from California.

Terrace Food Court, located on Level 1 in Ackerman Student Union, offers restaurants such as Epicuria, Rubio's Costal Grill, Panda Express, Veggie Grill, Jamba by Blendid, and more.

UCLA COVEL COMMONS

Level 3 Floor Plan

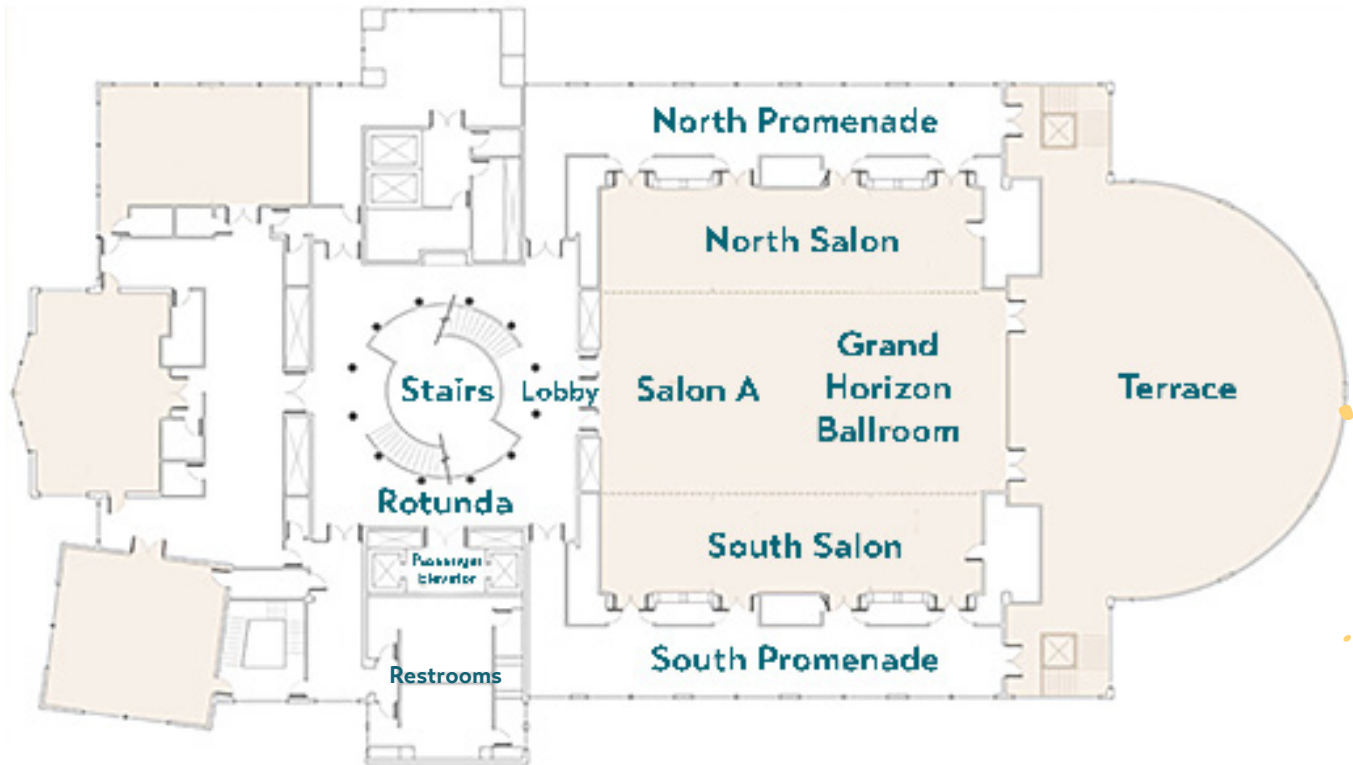

ACKNOWLEDGEMENTS

Thinking Gender 2023: "Transforming Research: Feminist Methods for Times of Crisis and Possibility" would not have been possible without the valuable input and contributions of our generous co-sponsors, featured facilitators, faculty moderators, participating scholars and students, and the Thinking Gender 2023 Planning Committee.

This year, the conference is held in a hybrid mode. In-person graduate student presentations are led by faculty moderators from across Southern California. We'd like to thank moderators Anurima Banerji, Michelle Caswell, Nguyễn Tân Hoàng, and Amy Ritterbusch.

We are grateful to Joycelyn Liu for designing the fabulous conference graphic design.

We thank UCLA Covell Commons, particularly Sales and Event Manager Madeline Samuel, for providing space and services. We also thank Jenston Production Systems for setting up and managing the AV equipment.

Finally, we are fortunate to have had a creative and hardworking planning committee for the conference. We thank CSW|Streisand Center Director Grace Hong; CSW|Streisand Center Associate Director and Thinking Gender 2023 Faculty Director Jasmine Nadua Trice; Thinking Gender 2023 Coordinator Zizi Li; Management Services Officer Rosa Chung; Program and Research Developer Katja Antoine; Administrative Specialist LaShae Robinson; Outreach; and Marketing Manager Rosie Grant. We are grateful for the contributions of our CSW|Streisand Center student assistants and researchers Lulah Balde and Anna Immergluck, and student designer Kaya Napachoti.

CO-SPONSORS

The UCLA Center for the Study of Women|Barbra Streisand Center would like to thank our generous cosponsors for contributing to the success of Thinking Gender 2023:

- American Indian Studies Center
- Anthropology Department
- Asian American Studies Center
- Asian American Studies Department
- Bixby Center on Population and Reproductive Health
- Center for the Study of Racism, Social Justice, and Health
- Center for Community Engagement
- Center on Reproductive Health, Law and Policy
- Center X
- Chicana/o and Central American Studies Department
- Chicano Studies Research Center
- Comparative Literature Department
- Critical Race Studies Program, UCLA Law
- Disability Studies
- English Department
- Graduate Division
- Humanities Division
- Institute for Research on Labor & Employment
- Institute of American Cultures
- Institute on Inequality and Democracy
- International Institute
- Justice, Equity, Diversity and Inclusion, David Geffen School of Medicine
- LGBTQ Campus Resource Center
- Luskin School of Public Affairs
- Penny Kanner Endowed Chair in Gender Studies
- Promise Institute
- Ralph J. Bunche Center for African American Studies
- School of the Arts and Architecture
- School of Theater, Film and Television
- Social Welfare Department
- Sociology Department
- Williams Institute at UCLA Law

1500 Public Affairs Building, Box 957222
Los Angeles, CA 90095-7222
www.csw.ucla.edu

DIRECTOR

Grace Kyungwon Hong

*Professor, Gender Studies and Asian
American Studies*

ASSOCIATE DIRECTOR

Jasmine Nadua Trice

*Associate Professor
Film, Television, and Digital Media*

ADVISORY COMMITTEE CHAIR

Timu Gallien

*Associate Professor
Civil and Environmental Engineering*

MANAGEMENT SERVICES OFFICER

Rosa Chung

PROGRAM AND RESEARCH DEVELOPER

Katja Antoine

ADMINISTRATIVE SPECIALIST

LaShae Robinson

OUTREACH AND MARKETING MANAGER

Rosie Grant

CONFERENCE COORDINATOR

Zizi Li

STUDENT ASSISTANTS

**Lulah Balde
Anna Immergluck
Kaya Napachoti**