

UCLA Center for the Study of Women

THINKING GENDER 30th Annual Graduate
Student Research Conference

***SEXUAL VIOLENCE as
STRUCTURAL VIOLENCE***

Feminist Visions of Transformative Justice

March 6, 2020

UCLA Carnesale Commons

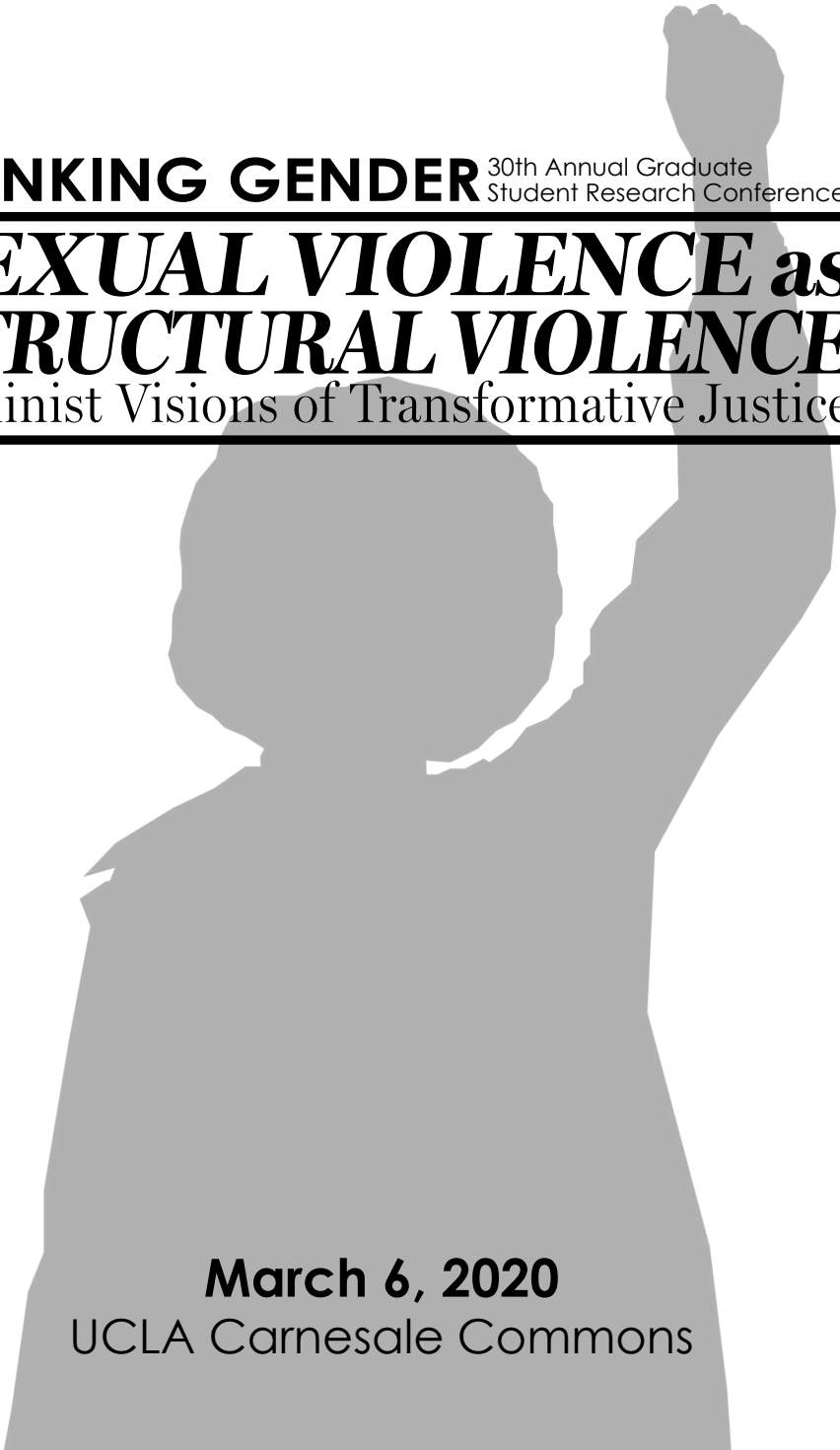

IMPORTANT INFORMATION

CHECK-IN/REGISTRATION: Registration tables are located in the Palisades Lobby on the 3rd floor of Carnesale Commons. CSW Staff will be wearing silver name badges with the CSW logo and will be available to provide assistance throughout the conference.

FOOD AND REFRESHMENTS: Complimentary refreshments are available in the morning and during the Reception in the Palisades Lobby for registered guests. Guests may also purchase food, snacks, and coffee at nearby campus locations. Please see page 11 for a list and map of nearby eateries.

INTERNET ACCESS: Guests can access Wi-Fi through the network “UCLA_WEB.” No password is required. The “eduroam” network is also accessible to guests from other campuses that participate in “eduroam.” You may log in using your own campus credentials.

RESTROOMS: All-Gender, Women’s, and Men’s Restrooms are available. Refer to the map on pages 12 and 13. Fragrance-Free handsoap will be available in all restrooms.

Level 2: All-Gender restrooms are located across from the Hermosa and Venice Rooms.

Level 3: Men’s and Women’s Restrooms are located to the left of the Palisades Ballroom.

BOOK SALES: The UCLA Bookstore will operate a book sales table to sell copies of Keynote Presenters’ books before (2:45-3:15 PM) and after (5:30-6:00 PM) the Keynote Panel in the Palisades Ballroom.

NOTICE OF PHOTOGRAPHIC AND MEDIA RECORDING: Photography, audio, and video recording may occur at this event. By entering the event premises, you consent to interviews, photography, audio recording, video recording, and their release, publication, exhibition, or reproduction to be used for news, webcasts, promotional purposes, telecasts, advertising, inclusion on websites, or any other purpose by the UCLA Center for the Study of Women.

KEEP THINKING GENDER FRAGRANCE-FREE! Members of our community experience severe reactions when exposed to synthetic fragrances. Help us keep Thinking Gender accessible! Avoid using or wearing scented products while at the conference, use the Fragrance-Free handsoap provided in restrooms, and respect the designated “Fragrance-Free” zones in the session rooms. **For more information, visit ShareTheAir.ucla.edu.**

The Center for the Study of Women at UCLA acknowledges the Tongva peoples as the traditional land caretakers of Tovaangar (Los Angeles basin, So. Channel Islands) and are grateful to have the opportunity to work for the taraaxatom (indigenous peoples) in this place. As a land grant institution, we pay our respects to Honuukvetam (Ancestors), ‘Ahihirom (Elders), and ‘eyoohiinkem (our relatives/relations) past, present and emerging.

UCLA CENTER FOR THE STUDY OF WOMEN PRESENTS

THINKING GENDER 30th Annual Graduate
Student Research Conference

***SEXUAL VIOLENCE as
STRUCTURAL VIOLENCE***
Feminist Visions of Transformative Justice

UCLA CARNESALE COMMONS
MARCH 6, 2020

CONFERENCE OVERVIEW

ALL DAY	Exhibit <i>Survived & Punished</i>
8:00 AM - 9:00 AM	Registration
9:00 AM - 10:30 AM	Panel 1 and Roundtable 1
10:30 AM - 10:45 AM	Break
10:45 AM - 12:15 PM	Panel 2 and Panel 3
12:15 PM - 1:15 PM	Networking Lunch <i>For presenters and invited guests only</i>
12:45 PM - 1:30 PM	Poster Session
1:30 PM - 3:00 PM	Panel 4 and Roundtable 2
3:00 PM - 3:15 PM	Break
3:15 PM - 5:30 PM	Keynote Panel <i>Transformational Justice: Refusing Criminalization and Sexual Violence</i>
5:30 PM - 6:30 PM	Reception and Poster Session

Thinking Gender is an annual public conference highlighting student research on women, sexuality, and gender across all disciplines and historical periods.

ALL DAY

EXHIBIT:

Survived & Punished

Palisades Lobby

Curated by **Grace Hong** and **Arielle Bagood**

9:00 AM - 10:30 AM

SESSION I

PANEL I / ROOM: HERMOSA

EXTRACTIVE ECONOMIES AND SEXUAL VIOLENCE

MODERATOR: **Leisy Abrego, Chicana/o Studies, UCLA**

Guadalupe Arellanes Castro, Ethnic Studies, UC Riverside

Existing and Dying at the Intersections and Margins: An Ethno-Racial Analysis of Femicide in Ciudad Juárez and Beyond

Laura Liévano-Karim, Social Welfare, UCLA

On Street Survival, Autonomous Bodies and Structures of Oppression: The Messiness of Naming and Framing Violence Against Street-Connected Girls in Uganda

Magally Miranda, Chicana/o Studies, UCLA

"Illegal Aliens" / Latina Feminists: Structural Vulnerability and the Battle Against Workplace Sexual Violence at Koch Poultry in Mississippi

Megan Spencer, Feminist Studies, UC Santa Barbara

Beyond Metaphor: Extractive Projects as Sexual Violence

ROUNDTABLE I / ROOM: VENICE

THE VIOLENCE OF METHOD: ETHNOGRAPHIC APPROACHES TO SEXUAL VIOLENCE

MODERATOR: **Lieba Faier, Geography and Gender Studies, UCLA**

Thalia Gomez-Quintana, Gender Studies, UCLA

Infrastructural Gender Based Violence and Yaqui Refusal

Nadeeka Karunaratne, Education, UCLA

*Creating Healing Spaces: A Study of Women of Color Trauma-Healing
Yoga Instructors*

Rosario Majano, Community Health Sciences, UCLA

*An Investigation of Sexual Harassment in Unionized Cannabis
Dispensaries*

10:45 AM - 12:15 PM

SESSION II

PANEL 2 / ROOM: HERMOSA

**INTERSECTIONS AND INSTITUTIONS: POLICIES,
PROGRAMS, AND THEIR LIMITS**

MODERATOR: **Jennifer Wagman**, Community Health Sciences,
UCLA

Alana Dionne Fields, Sociology, University of Pittsburgh

*“Locker Room Talk”: An Evaluation of a Violence Prevention Program
Attempting to Challenge Gender Norms*

Nadeeka Karunaratne, Education, UCLA, **Elaine Chan**, David Geffen
School of Medicine, UCLA, and **Ally Power**, Epidemiology, UCLA

*Student, Staff, and Faculty Perspectives of Compelled Disclosure Policies
in Higher Education*

Soukayna Mniaï, American Studies, Université Paris Nanterre

*Should Sexual Violence Prevention Programs on College Campuses Stop
Using the Concept of Consent?*

PANEL 3 / ROOM: VENICE

**LEGACIES OF EMPIRE AND SETTLER
COLONIALISM**

MODERATOR: **Yogita Goyal**, African American Studies and
English, UCLA

Anisha Ahuja, Cultural Studies, Claremont Graduate University

*19th Century Courtesans and Empire: Governmentality and Cultural
Transformation as Sexual Violence*

Clementine Bordeaux, World Arts and Cultures/Dance, UCLA

A Silent Pow Wow for MMIW: Indigenous Performance as a Way to Map Resistance

Kaity Matrassi, French and Romance Philosophy, Columbia University

Arab-Muslim Women's Responses to Sexualized and Racialized Violence in France

12:45 PM - 1:30 PM

POSTER SESSION

Palisades Lobby

Clarissa Campos, Sociology, CSU Northridge

Becoming an Activist: Carceral Trauma and Identity Transformation in Prison Reform

Juan J. Esparza, Women's Studies, CSU Fresno

Bodies of Silence as Bodies of Evidence: Unpacking Intersectional Failure in South Africa's Truth and Reconciliation Commission

Shawna Irissarri, Women's Studies, CSU Fresno

Lesbian Women, Heterosexual Men and Gender Subversion: How Gender Expression Influences the Treatment of Lesbian Women

Morgan Koziol, Ronald E. McNair Scholars, Baylor University

Intersectionality of Sexual Harassment Perceptions

Megan Merati, Gender Studies, UCLA

Pelvic Trauma and Holistic Healing: Effects on Body, Mind, and Spirit

Atreyi Mitra, Institute of Society and Genetics, UCLA and

Aaliyah Sade, World Arts and Cultures/Dance, UCLA

Evaluating the Knowledge of Campus Sexual Violence Prevention Education and Resources at UCLA

Shannon Moore, Women, Gender, and Sexuality Studies, Binghamton University

Carceral Care: Institutional Treatment of Injury in Relationship Violence

Joelle Rosenberg, Sociology, UCLA

"¡Asesinas, terroristas, putas!": Genocide, Gender, and Sexual Violence under the Argentinian Dictatorship of 1976-1983

Meelissa Tapia-Cortez, Gender Studies and History, UCLA
*Constructing Criminality: Interactions between Undocumented
(Im)migrant Women of Color, Patriarchal Violence, and the State*

1:30 PM - 3:00 PM

SESSION III

PANEL 4 / ROOM: HERMOSA

**CONCEPTUALIZING SEXUAL VIOLENCE AND THE
POLITICS OF KNOWLEDGE**

MODERATOR: Lee Ann Wang, Asian American Studies and
Social Welfare, UCLA

Abigail Jean Beck, History, Claremont Graduate University
*The Form of a Woman: Memorializing Wartime Rape in the European
and Pacific Theaters of WWII*

Catherine Brist, English and Women's Studies, University of Michigan
*Personal Stories, Structural Problems: Toward an Ethical Narrative of
Sexual Violence*

James L. Austin, Visual Studies, UC Irvine
Epistemology of "The Moment of Truth"

Meghan Warner, Sociology, Stanford University
Becoming a Survivor? Identity Creation Post-Violence

ROUNDTABLE 2 / ROOM: VENICE

**CARCERALITY AND ABOLITION: SECURITY,
STRUGGLE, AND STRATEGIES FOR SAFETY**

MODERATOR: Alisa Bierria, Ethnic Studies, UC Riverside

Melanie Brazzell, Sociology, UC Santa Barbara
*From Carceral Feminist Security to Abolitionist Safety: Transformative
Justice for Survivors of Gender-based Violence*

Marina de Oliveira Reis, Law, UCLA
*Maria da Penha Law, Black Feminism and Abolitionism: the Brazilian
experience*

Ayanna De’Vante Spencer, Philosophy, Michigan State University
Tracking Carceral Epistemology through the Criminalization of Black Girl Survivors

Joss Greene, Sociology, Columbia University
Struggling for Safety: Survival Strategies of Incarcerated Trans Women

Rosie Stockton, Gender Studies, UCLA
“A Living Death Penalty”: Necropolitics, Social Reproduction, and Abolitionist Tactics of DROP LWOP

3:15 PM - 5:30 PM

KEYNOTE PANEL
Palisades Ballroom

OPENING

TOYPURINA: BLOODLINES OF RESISTANCE

Weshoyot Alvitre, Artist, Tongva, Los Angeles Basin

PANEL

**TRANSFORMATIONAL JUSTICE: REFUSING
CRIMINALIZATION AND SEXUAL VIOLENCE**

MODERATOR: **Sarah Haley**, Gender Studies and African
American Studies, UCLA

Mariame Kaba, Project NIA; Barnard Center for Research on Women

Mimi Kim, Social Work, CSU Long Beach

Emily Thuma, American Politics and Public Law, University of
Washington Tacoma

5:30 PM - 6:30 PM

**CONFERENCE RECEPTION AND
POSTER SESSION**
Palisades Lobby

KEYNOTE PANELISTS



WESHOYOT ALVITRE is a female illustrator and comic book artist. She has a BA in Fine Art and studied illustration and animation. She is Tongva and Scottish. Alvitre has contributed to many award-winning books, including the Eisner award-winning *Umbrella Academy* (Darkhorse Comics) and *Little Nemo: Dream Another Dream* (Locust Moon Press). Her most recent projects include art for the graphic novel *GHOST RIVER* (Native Realities Press/Library Company of Philadelphia/Pew Arts & Heritage) based on the Paxton Massacre of the Conestoga people in Philadelphia, *At The Mountains Base* (Kokila), and art direction on the educational video game *When Rivers Were Trails*, which gives a Native perspective on westward expansion of the 1890s. She is currently writing and drawing *Toypurina: Our Lady of Sorrow*.



MARIAME KABA is an organizer, educator, and curator who is active in movements for racial, gender, and transformative justice. She is the founder and director of Project NIA, a grassroots organization with a vision to end youth incarceration. She has co-founded multiple organizations and projects over the years, including We Charge Genocide, the Chicago Freedom School, the Chicago Taskforce on Violence against Girls and Young Women, Love & Protect, and most recently, Survived & Punished.

As a Researcher in Residence at the Barnard Center for Research on Women, Kaba works with Andrea J. Ritchie, fellow Researcher in Residence, on a new Social Justice Institute (SJI) initiative, Interrupting Criminalization: Research in Action.

Kaba is on the advisory boards of the Chicago Torture Justice Memorials, Critical Resistance, and the Chicago Community Bond Fund. Her writing has appeared in numerous publications, including The Nation Magazine, The Guardian, The Washington Post, In These Times, Teen Vogue, The New Inquiry, and more. She runs the Prison Culture blog. Kaba's work has been recognized with several honors and awards.

SUPPORT CSW!

Events like Thinking Gender would not be possible without the generous support of our co-sponsors, collaborators, and benefactors.

If you are interested in supporting the next generation of research on women and gender by donating to CSW, please visit csw.ucla.edu or speak to a staff member at the Registration Table.

KEYNOTE PANELISTS



MIMI KIM is a long-time advocate and activist working on issues of gender-based violence in communities of color. She is a co-founder of Incite!: Women, Transgender and Gender Non-Conforming People of Color Against Violence. In 2004, she established Creative Interventions, which helped to develop collective, liberatory, and non-criminalizing approaches to address and end domestic and sexual violence, and has worked actively to develop feminist community accountability and transformative justice political frameworks and practices. Kim's research on the historical development of carceral feminism and the contemporary transformative justice movement includes *The Carceral Creep: Gender-Based Violence, Race, and the Expansion of the Punitive State, 1973-1983* (2019). Kim is an Assistant Professor of Social Work at California State University, Long Beach.



EMILY THUMA is an Assistant Professor of U.S. Politics and Law at the University of Washington Tacoma, and formerly an Assistant Professor of Gender and Sexuality Studies at the University of California, Irvine. She researches and teaches at the intersections of 20th-century U.S. history and politics, feminist and queer studies, critical race and ethnic studies, legal studies, and carceral studies. Her book, *All Our Trials: Prisons, Policing, and the Feminist Fight to End Violence*, was published by the University of Illinois Press in 2019. A long-time participant in movements for racial and gender justice, Thuma is a member of the California Coalition for Women Prisoners and a co-coordinator, with Alisa Bierria, of the Feminist Decarceral Research Initiative.



SARAH HALEY (Moderator) is an Associate Professor of Gender Studies and African American Studies at UCLA. She has research and teaching investments in black feminism, gender history, carceral studies, labor, and black radicalism. She is the author of *No Mercy Here: Gender, Punishment, and the Making of Jim Crow Modernity* (UNC Press, 2016), which examines the lives of imprisoned women in the U.S. South from the 1870s to the 1930s and the role of carcerality in shaping cultural logics of race and gender under Jim Crow. She is currently working on a black feminist history of the rise of the contemporary carceral state that interrogates the role of state intrusion and violation of black domestic space. Her research has been supported by the Gilder Lehrman Center for the Study of Slavery, Resistance, and Abolition, the Ford Foundation, and the Woodrow Wilson Foundation. She has also worked as a paralegal for the New York Office of the Federal Public Defender and as a labor organizer with UNITE-HERE.

EATERIES

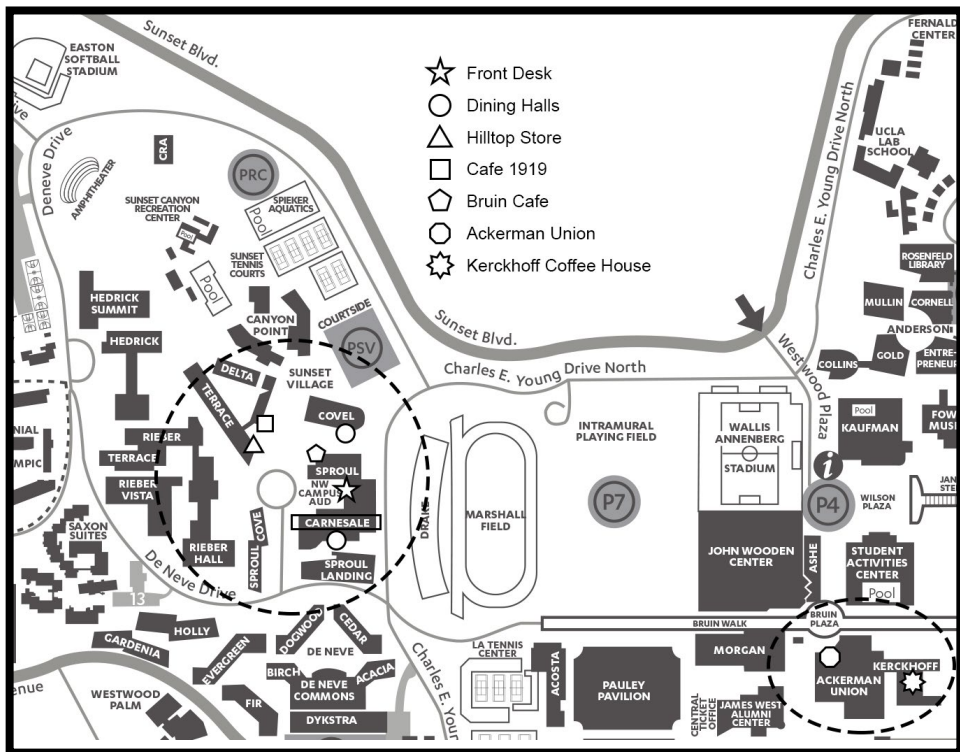

Residential Dining, located around the residential hill, offers several grab-and-go locations that accept cash/card payment. These are Café 1919 (card only with photo ID) and Bruin Café. Dining halls offer buffet dining and meal tickets that can be purchased at residential hall front desks. The nearest dining halls and front desks are indicated on the map.

UCLA Hilltop Store, located across from Café 1919, offers a variety of snack and beverage items available for purchase via cash/card.

Avenue A, located on the A-Level in Ackerman Student Union, offers select restaurants including Taco Bell, Carl's Jr., Jamba Juice, and more.

Terrace Food Court, located on Level 1 in Ackerman Student Union, offers restaurants such as Veggie Grill, Rubio's Fresh Mexican Grill, Panda Express, Wolfgang Puck, and more.

Kerckhoff Coffeehouse, located in Kerckhoff Hall near Ackerman Student Union, offers coffee, tea, other beverages, and some select grab-and-go style food options.

UCLA CARNESALE COMMONS - LEVEL 2

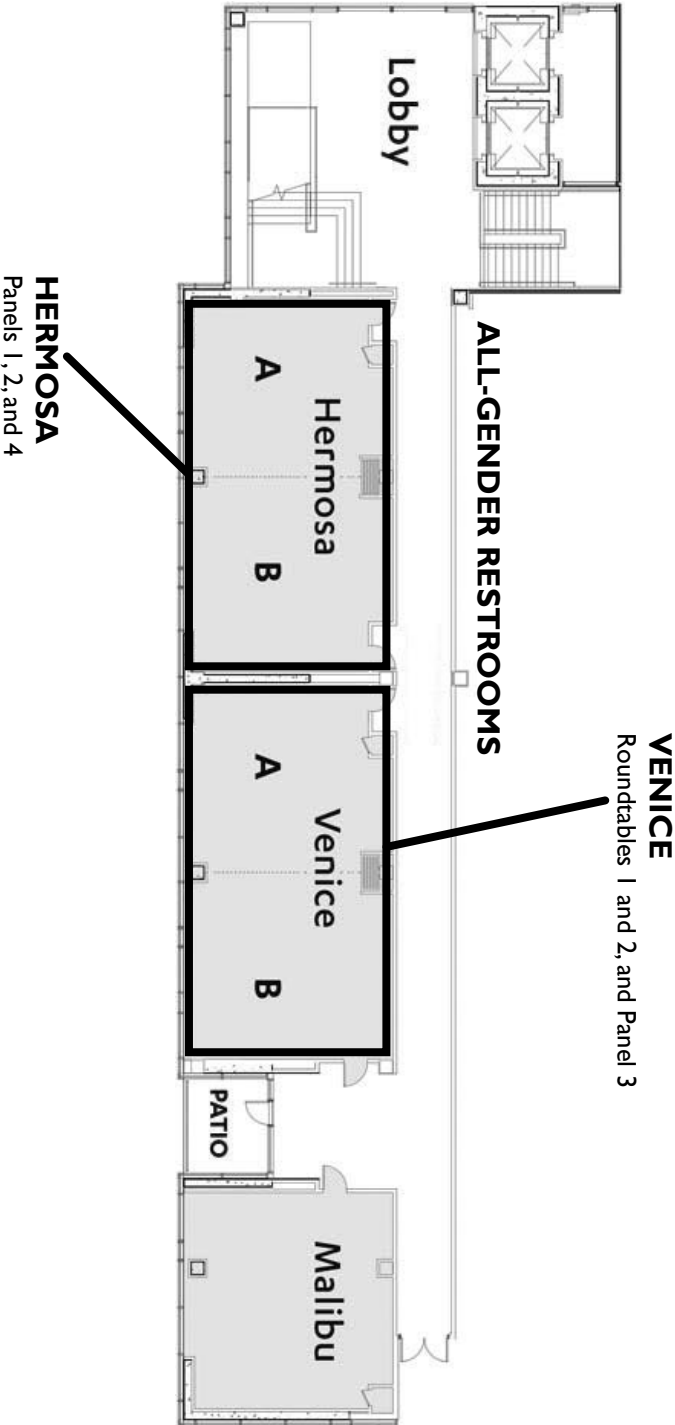

HERMOSA
Panels 1, 2, and 4

VENICE
Roundtables 1 and 2, and Panel 3

PALISADES LOBBY
Registration Table, Exhibit,
and Poster Session

PALISADES BALLROOM
(A, B, C, F)
Keynote Panel

RESTROOMS →

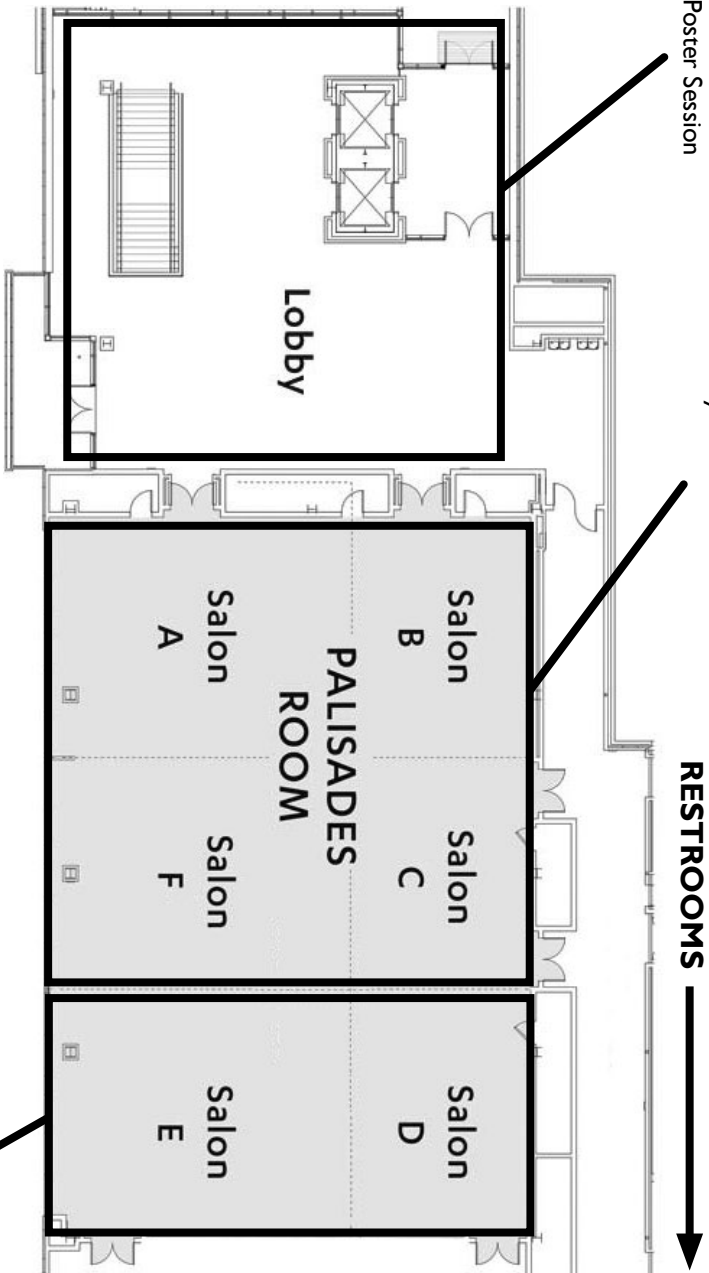

PALISADES E
Networking Lunch for presenters
and invited guests only

ACKNOWLEDGEMENTS

Thinking Gender 2020: *Sexual Violence as Structural Violence: Feminist Visions of Transformative Justice* would not have been possible without the valuable input and contributions of our generous co-sponsors, keynote participants, faculty moderators, participating scholars and students, and the Thinking Gender 2020 Planning Committee.

First and foremost, the Center for the Study of Women would like to thank two leaders on campus who provide constant and substantial support of the conference and CSW as a whole: Dean of Social Sciences Darnell Hunt and Vice Chancellor of Equity, Diversity, and Inclusion Jerry Kang.

This year, we offered engaging components to enhance the conference experience, particularly Roundtable Sessions and an interactive Exhibit. The Roundtable Sessions stray from the traditional paper format by featuring the work of students with papers in development, allowing for more participation from scholars across the field. The Survived & Punished (S&P) Exhibit centers around a postcard-writing and petition-signing station as well as displays and digital media of short videos provided by S&P and the California Coalition for Women Prisoners (CCWP), offering participants the opportunity to watch educational short videos about survivors of sexual and domestic violence imprisoned for self-defense, send postcards urging California Governor Newsom to decriminalize survivors and drop life without parole sentences of all survivors of domestic and sexual violence, and sign online petitions to free survivors in California prisons.

We also wish to acknowledge the members of the Thinking Gender 2020 Selection Committee: Rachel C. Lee, CSW Director; Grace Hong, CSW Associate Director and Thinking Gender 2020 Curator; Bri-Ann Hernandez, Thinking Gender 2020 Coordinator; Gillian Gower, CSW Interim Program and Research Developer; and Magally Miranda, UCLA Chicana/o Studies Graduate Student.

We thank UCLA Carnesale Commons, particularly Catering Sales Manager Jane Kim, for providing space and services.

Finally, we are fortunate to have a creative and hardworking Planning Committee for the Conference. We thank Grace Hong; Bri-Ann Hernandez; Kristina Magpayo Nyden, Management Services Officer; Melissa Jamero, Administrative Specialist; and Arielle Bagood, Program Coordinator. We are grateful for the contributions of our CSW student assistants and researchers: Rachel Forrest, Kelsey Kim, Joycelyn Liu, Aye Pyae, and Nic Yiu.

CO-SPONSORS

Thinking Gender is proud to be backed by UCLA Equity, Diversity, and Inclusion.

The UCLA Center for the Study of Women would like to thank our generous co-sponsors for contributing to the success of Thinking Gender 2020:

- African American Studies Department
- African Studies Center
- American Indian Studies Center
- American Indian Studies Program
- Anthropology Department
- Asian American Studies Department
- Asian American Studies Center
- Bixby Center on Population and Reproductive Health
- Black Male Institute and Pritzker Center for Strengthening Children and Families
- Bruin Consent Coalition
- Campus Assault Resources and Education (CARE)
- Kaiser Permanente Center for Health Equity
- Center for Health Policy Research
- Center for the Study of Racism, Social Justice, & Health
- Center X
- Chicana/o Studies Department
- Chicano Studies Research Center
- Community Health Sciences Department
- Comparative Literature Department
- Criminal Justice Program, UCLA School of Law
- Disabilities Studies Program
- Education Department
- English Department
- Fielding School of Public Health
- Gary B. Nash Endowed Chair in U.S. History
- Gender Studies Department
- Healthy Campus Initiative
- Humanities Division
- Information Studies Department
- Institute for Research on Labor & Employment
- Institute of American Cultures
- Institute of Transportation Studies
- Institute on Inequality and Democracy
- International Development and Policy Outreach
- International Institute
- Iris Cantor-UCLA Women's Health Center
- Labor Center
- Latin American Institute
- Latino Policy and Politics Initiative
- Office of Residential Life
- Penny Kanner Endowed Chair in Women's Studies
- Promise Institute for Human Rights
- Ralph and Goldy Lewis Center for Regional Policy Studies
- Ralph J. Bunche Center for African American Studies
- School of Medicine-Office of Diversity Affairs
- School of Nursing
- School of Theater, Film, and Television
- Social Sciences Division
- Social Welfare Department
- Sociology Department
- UC Speaks Up
- UC Global Health Institute's Center of Expertise on Women's Health, Gender and Empowerment
- Veterans Legal Clinic
- Urban Planning Department
- World Arts and Cultures/Dance Department



ucla center for the study of women
research that rethinks

csw@csw.ucla.edu • csw.ucla.edu
box 957222 • public affairs 1500
los angeles, ca 90095-7222

DIRECTOR

Rachel C. Lee
*Professor, English, Gender Studies, and
Institute for Society and Genetics*

ASSOCIATE DIRECTOR

Grace Kyungwon Hong
*Professor, Gender Studies and
Asian American Studies*

**ADVISORY COMMITTEE CHAIR AND
DIRECTOR, BLACK FEMINISM INITIATIVE**

Sarah Haley
*Associate Professor, Gender Studies
and African American Studies*

**SENIOR FACULTY RESEARCH
ASSOCIATE**

Jessica Cattelino
Associate Professor, Anthropology

MANAGEMENT SERVICES OFFICER

Kristina Magpayo Nyden

PROGRAM AND RESEARCH DEVELOPER

Katja Antoine

ADMINISTRATIVE SPECIALIST

Melissa Jamero

PROGRAM COORDINATOR

Arielle Bagood

CONFERENCE COORDINATOR

Bri-Ann Hernandez

GRADUATE STUDENT RESEARCHERS

Kelsey Kim, Nic Yiu

STUDENT ASSISTANTS

Rachel Forrest, Joycelyn Liu, Aye Pyae

Join the conversation!

Follow **@UCLA_CSW** on Twitter and **@UCLACSW** on Facebook!

Share your Thinking Gender experience.

Write about the conference for our blog!

Email **thinkinggender@women.ucla.edu** for details.



eScholarship
University of California